

# ÜBERSICHTSZEICHNUNG ASSEMBLY DRAWING

# GHOST

**LECTOR 5.7+**  
TITANIUM GRAY / STAR WHITE / BIOT RED



**LECTOR 6.7+**  
TITANIUM GRAY / BIOT RED / STAR WHITE



**LECTOR 8.7+**  
TITANIUM GRAY / VOLCANO ORANGE / PALLADIUM SILVER



**LECTOR X 5.7+**  
TITANIUM GRAY / NIGHT BLACK / NEON YELLOW



## HYB LECTOR & HYB LECTOR X (MY18)

2017-12-04

V01

# ÜBERSICHTSZEICHNUNG ASSEMBLY DRAWING

# GHOST

**Hinweis:** Bei den Schrauben muß mittelfeste Gewindegewissung verwendet werden.  
**Rote Flächen müssen gefettet werden.**

**note:** use medium strength screw lock for screw threads.  
**red surfaces has to be greased.**

**Hinweis:** Kabelführungen modellabhängig  
**note:** cableguides depends by model

**Hinweis:** Gabel nur bei HYB LECTOR X verbaut!  
**note:** fork just mounted at HYB LECTOR X!

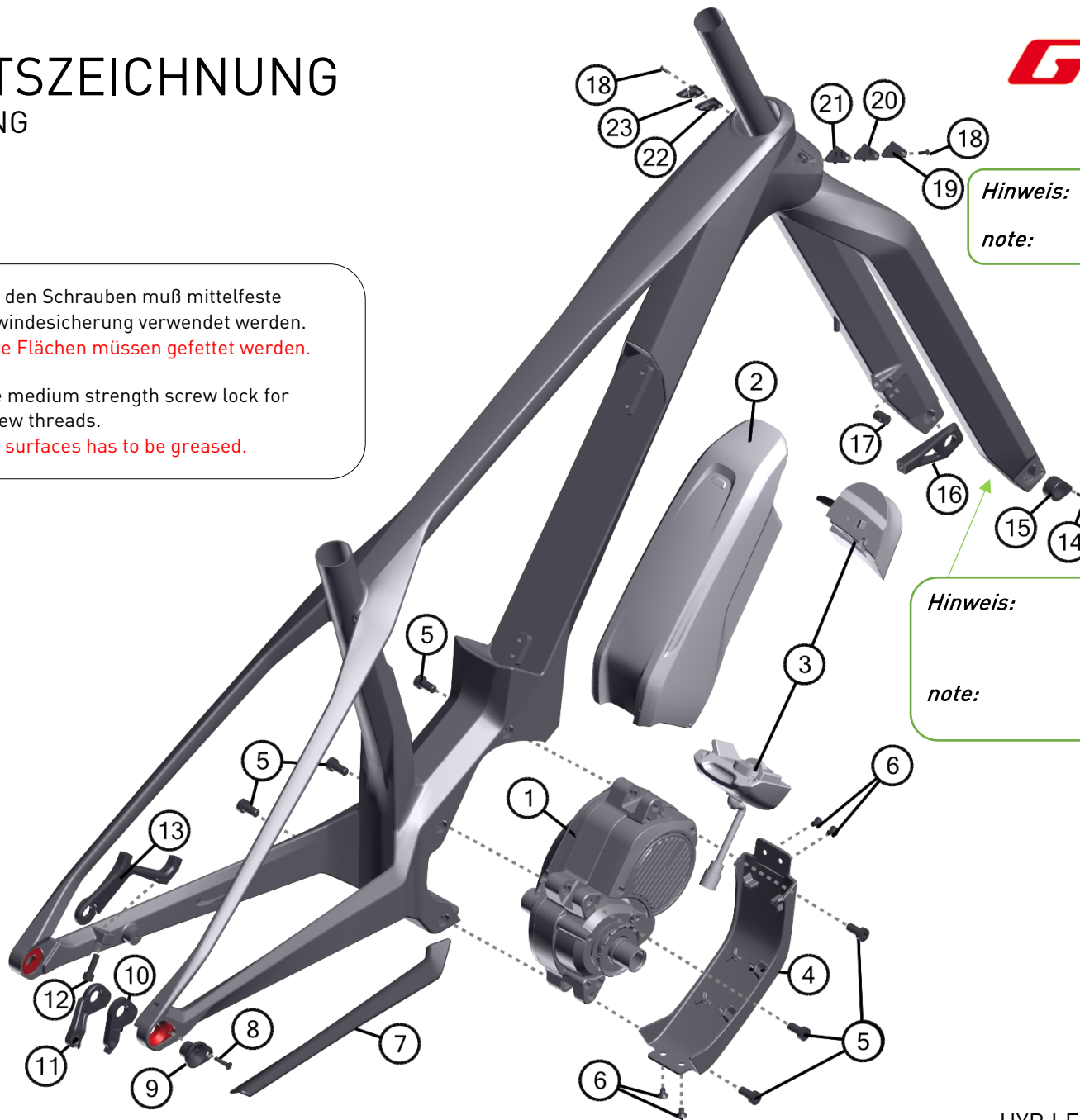

# ÜBERSICHTSZEICHNUNG

## ASSEMBLY DRAWING

**GHOST**

BOM-ID	Description	Specification	Torque	Item no.	QTY
1	Drive Unit DU-E8000			EL0222	1
2	Battery, BT-E8010			EL0159	1
3	Battery Mount & Battery Lock			EL0158 & EL0155	1
4	Engine protection			FRPR0022	1
5	DU Screw	Hex 5 - M8 x 20mm (8.8)	12 Nm	SM1616	6
6	Engine protection screw		6 Nm	FRSC0022	4
7	C/S protector			SM1669	1
8	Flat Head Screw M4	T15 - M4 x 20mm	0,8 Nm	FRSC0061	1
9	Hanger Mount			FRNT0061	1
10	SRAM Hanger (B2)			FRHG0021	1
11	Shimano Hanger (B1)			FRHG0022	1
12	Post Mount Screw	T30 - M6 x 26mm	8 Nm	SM1372	1
13	Disc Brake Mount			FROT0013	1
14	cylindrical flat head Screw	Hex 3 - M3 x 8mm	0,5 Nm	FRSC0027	1
15	hanger mount			FRNT0002	1
16	Brake Mount			FROT0001	1
17	Disconnect brake mount nut			FRNT0006	1
18	Headtube flat Screw	T10 - M3 x 10mm		SM1524	2
19	HT cap right; no hole			SM1504	1
20	HT cap right; 1 hole; Dropper			SM1399	1
21	HT cap right 2 hole; Dropper + FD			SM1402	1
22	HT cap left; RB & RD			SM1401	1
23	HT cap left; RB & RD DI2			SM1509	1